



Feature Focus: Softphones



iCS has teamed up with leading telecoms system provider Splice.com. Splice.com's range of IP softphone apps allows you to turn your laptop, PC, smartphone or tablet into a highly-featured business phone that's fully integrated with your Splice.com SelectVoice system.

Navigate Pro for Windows

Whether you need to work in the office, or securely away from it, Navigate Pro gives you a fully featured IP softphone* on your PC, providing easy access to both every-day and advanced system features on Splice.com's SelectVoice platform.

The option to fully integrate Navigate Pro with Microsoft's Skype for Business, with the ability to dock provides a single user interface for all forms of communication and interaction. This makes Navigate Pro a powerful business tool, promoting closer working relationships with both internal staff, external suppliers and customers, using cross-federation, for a full Unified Communication experience.

Skype With Phone
User Status

Navigate Control
Panel Docked



Navigate Favourites

Navigate History

Navigate Call Panel

Navigate Pro – Microsoft Desktop Integration Features

Integrates with Skype for Business and Outlook Contacts/Calendar. Option to dock with Skype for Business

Bi-directional updates for In Call and Out Of Office status and Skype user status options

Integrated Skype Contact search

Click to dial from Skype Contact Card/Outlook Contact Card/Skype Presence Indicator

Highlight and click to dial any telephone number in a Microsoft app

Park a call dialled from Skype Contacts on Navigate Pro

Seamless transition from Skype Integrated Messaging (IM) to Navigate Pro

"In Video Call" option to change the Do Not Disturb status on Navigate Pro

Inbound telephone call tagged with Skype Contact name

Skype Contact indicator against Navigate Pro Call History entries

Live Skype availability indicator (not connected/connecting/connected)

Navigate Auto Start-up with Skype

Comprehensive In-Call Control options (switch/conference/blind transfer/announced transfer/drop call)

*Navigate Pro can also be used as a Phone Partner app.



Feature Focus: Softphones

iPCS for Apple IOS, Android and Windows Phones

Splicecom's iPCS application allows your workforce to now use just one device - their smartphone - for all their business needs, thus reducing costs, desk real estate and the complexity associated with using multiple devices.

iPCS takes office mobility to the next logical stage, enabling Apple, Android and Windows smartphones and tablets to be utilised as highly featured business phones. Running iPCS on your mobile device provides an alternative to deskphones or PC softphones and offers a differentiated solution to DECT or SIP/WiFi wireless phones.

Providing a fully integrated IP Phone solution for the entire workforce, iPCS works in the same way as Splicecom's PCS system phones, empowering employees with access to key business features wherever they might be - at their desk or away from it. iPCS utilises WiFi or 4G/3G connectivity to provide direct integration with Splicecom's SelectVoice 1000 platform.

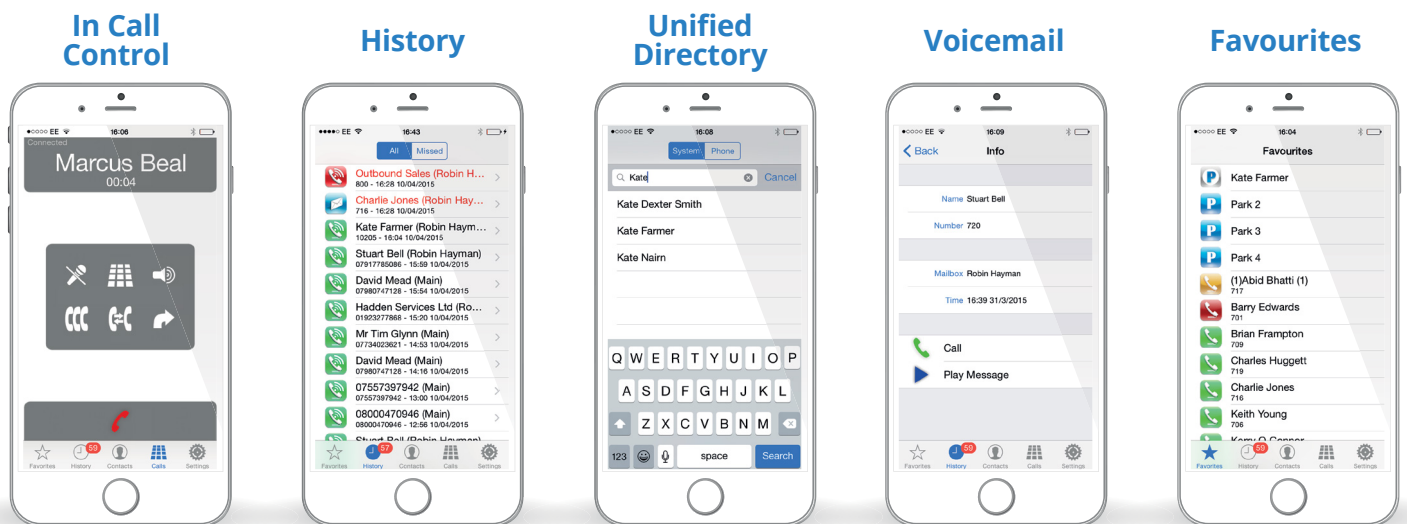

Description	Navigate Pro	iPCS
Runs on	Windows 10 PCs and Laptops	Apple iOS, Android, Windows Phone
Favourites	✓	✓
Unified Splicecom Directory	✓	✓
Call History	✓	✓
Voicemail Playback	✓	✓
Quick Mobility Settings	✓	✓
Call Recording	Requires Vision Record. Includes the ad-hoc record feature as standard	Requires Vision Record